



**FT-30-RD Centrifugal Feeder**  
 Designed for Quiet, High Speed Feeding



**Product Overview:**

Hoppmann's standard FT-30 rigid disc centrifugal feeder is designed to feed a variety of products with its unique bowl design. Product is metered into the bowl and brought out to the bowl rim where a series of qualifiers gently orient the part for transfer to various downstream inline devices.

**Product Specifications:**

	<u>ANSI</u>	<u>Metric</u>
A. Outside Diameter	40.21"	1021mm
B. Frame Height	22.79"	579mm
C. Discharge Height	17.51"	445mm
D. Bowl Outside Diameter	36.13"	918mm
E. Bowl Inside Diameter	28.79"	731mm
F. Rim Width	3.67"	93mm
G. Bowl Depth	5.65"	144mm
H. Level Foot Adjustment	3.97" ± 1"	101mm ± 25mm

**Standard Models:**

Part Number	<u>FT301RLDSA</u>	<u>FT301RLASA</u>
Motor Style	DC	AC
Motor Voltage	90V	230/460V
Horsepower	1/3 hp	249 W

**Required Accessories:**

	<u>CW</u>	<u>CCW</u>
Square Frame		
Backup Ring .....	BUCWFT30SU	BUCCF30SU

**Standard Features:**

- All stainless steel construction
- Square tooling frame
- FDA approved ABS vacuum formed disc
- Polyurethane foam bowl
- Panel mount controller card

**Available Options:**

- Polycarbonate covers
- Dual motor drive system
- Washdown motor(s)
- NEMA 1 encased controller
- Teflon hard-coated finished aluminium bowl

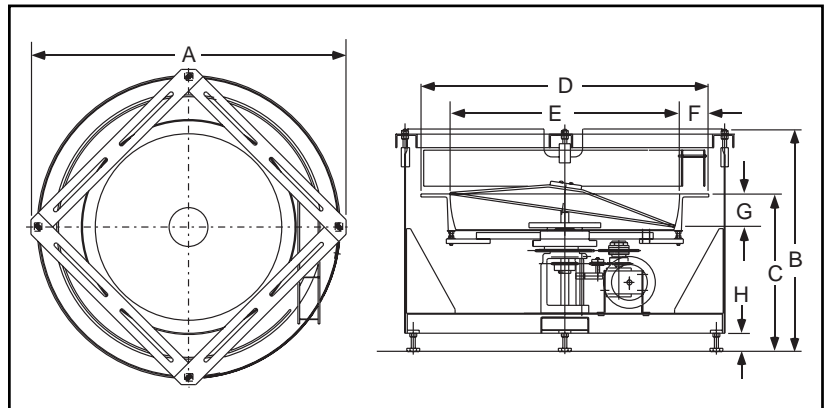

Hoppmann Corporation strives to improve its products and reserves the right to change or discontinue specifications & designs shown in this brochure without notice and without incurring obligation. 06/05

**We Can Handle It.**

**Your Local Representative:**

Automatic Feeder Company Inc.  
 921 Albion Avenue Schaumburg, IL 60193-4550  
 Phone: (847) 534-2300 Toll-Free: (888) 534-2340 Fax: (847) 534-2354  
 www.automaticfeeder.com Email: sales@automaticfeeder.com

