

# Stainless steel conveyor system XMX

## System information



### Chain width 83 mm



Item width .....	20–200 mm
Maximum item weight	
Horizontal transport .....	15 kg
Vertical transport.....	10 kg
Maximum weight on conveyor.....	200 kg
Maximum conveyor length .....	30 m

### Features

- Wide range of wet applications
- Wedge conveyors
- High speed solutions
- Many chain types available from the standard XM range
- Higher capacity than XL

### Examples of application areas

Filling lines within the food, personal products and liquid pharmaceuticals segments.

### Technical characteristics

Drive unit capacity.....	1250 N
Chain tension limit.....	1250 N
Beam width .....	85 mm
Chain width .....	83 mm

P0  
X45  
XS  
XL  
XLP  
X85  
X85P  
XH  
XK  
XKP  
XB  
GR  
CS  
XT  
XC  
XF  
XD  
FST  
XMY  
XLX  
**XMX**  
GRX  
CSX  
ELV  
CTL  
TR  
APX  
IDX

# Chains XMX

## Plain chain

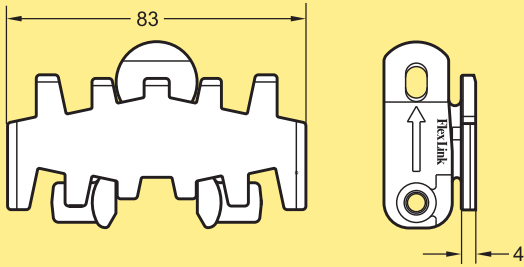

Plain chain  
Length 5 m

**XMTP 5**

Link kit \*

**5056281**

\* Link kit contains 10 links, 10 pivots, 10 steel pins

## Flat friction top chain

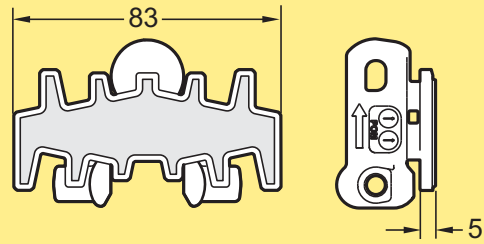

Flat friction top chain  
Length 5 m

**XMTP 5 FA**

Friction top link kit \*

**5059114**

\* Link kit contains 10 links, 10 pivots, 10 steel pins

## Friction top chain

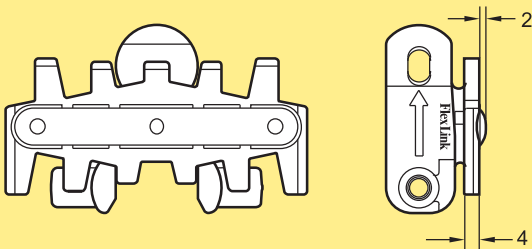

Friction top chain  
Length 5 m

**XMTP 5 F#**

Enter cleat frequency (1–20) instead of # in product designation.

Friction top link kit \*

**5056102**

\* Link kit contains 10 links, 10 pivots, 10 steel pins

## Roller top chain

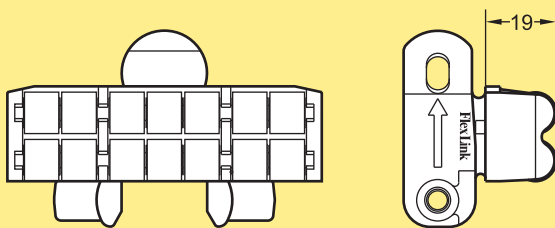

Roller top chain  
Length 5 m

**XMTR 5**

Roller top link

**5056100**

\*Note. This link cannot be combined with plain links in conveyors with bends.

# Conveyor beam XMX

P0

**Conveyor beam**

Beam  
Length 3 m  
Length to order (0,2–3,0 m)

**XMCBX 3**  
**XMCBX L**

**Beam section for chain installation**

Beam section for chain installation **XMCCX 160**  
*Including connecting strips*  
*Screws and nuts for the connecting strips are not included*

X45  
XS  
XL  
XLP  
X85  
X85P  
XH

## Beam accessories XMX

XK

**Connecting strip**

Connecting strip **XLCJX 6x160**  
*Mounting: M6S 8x12 A4 (4), BRB 8,4x24 A4 (4)*  
*Screws and nuts are not included*

XKP  
XB  
GR  
CS  
XT

## Slide rails XMX

XC

**Plastic slide rail for XL, X85, XMX, XH beam**

Slide rail  
Length 25 m  
Polyethylene (PE) (Grey)  
PVDF (Transparent white)  
UHMW-PE (White)  
PA-PE (Grey)

**XLCR 25**  
**XLCR 25 P**  
**XLCR 25 U**  
**XLCR 25 H**

*See Appendix A, page 407 for selection guidelines and assembly instructions.*

XF  
XD  
FST  
XMY  
XLX

**Stainless steel rivet**

Stainless steel rivet, 4 mm **XLAHX 4x6**  
*Note. Must be ordered in multiples of 50*

XXM

**Mounting tool for slide rail**

Mounting tool XMX **XMMR 140**

**Plastic screw for slide rail**

Plastic screw 5 mm for XL-XMX-XH **XLAG 5**  
*Note. Must be ordered in multiples of 50*

GRX  
CSX  
ELV  
CTL  
TR  
APX  
IDX

## Slide rails XMX (continued)

### Drill fixture for slide rail

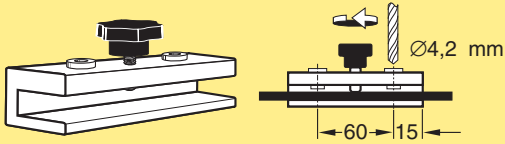

Drill fixture for slide rail

**3920500**

### Rivet crimping clamp for XL-X85/XM-XH

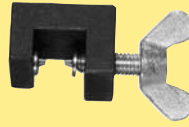

Rivet crimping clamp  
For 4 mm rivets

**3923005**

### Rivet crimping pliers for XL-X85/XM-XH



Rivet crimping pliers  
For 4 mm rivets

**5051395**

## End drive units XMX

### End drive unit HLP

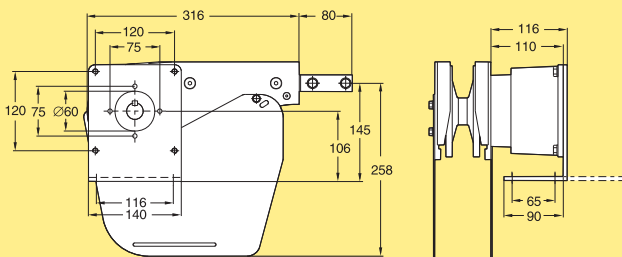

End drive unit  
Transmission on left side  
Fixed/variable speed \*  
Without motor

**XMEBX  
XMEBX 0 HLP**

Effective track length: 0,80 m  
\* Use online configurator when ordering.

### End drive unit HRP

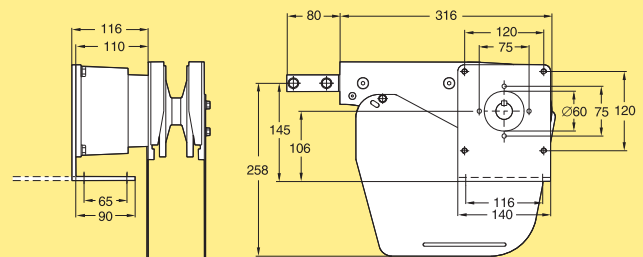

End drive unit  
Transmission on right side  
Fixed/variable speed \*  
Without motor

**XMEBX  
XMEBX 0 HRP**

Effective track length: 0,80 m  
\* Use online configurator when ordering.

### Drive unit shaft kit

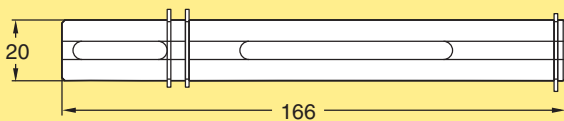

Drive unit shaft kit for stainless  
steel drive units Series X

**5051185**

For SEW SA37 gearbox. Including the necessary  
mounting hardware

# Idler end unit XMJ

**Idler end unit**

Idler end unit **XMEJX 315**  
 Effective track length: 0,80 m

# Wheel bends XMJ

**Wheel bend, 30°**

Wheel bend, 30° **XMBHX 30R160**  
 Effective track length: 0,25 m (2-way 0,50 m)

**Wheel bend, 180°**

Wheel bend, 180° **XMBHX 180R160**  
 Effective track length: 0,65 m (2-way 1,30 m)

**Wheel bend, 45°**

Wheel bend, 45° **XMBHX 45R160**  
 Effective track length: 0,30 m (2-way 0,60 m)

**Safety cover for wheel bend XMBHX**

Safety cover for wheel bend XMBHX **5056996**  
 Each item consists of two (2) covers.  
 Use the existing screw and washer for assembly.

**Wheel bend, 90°**

Wheel bend, 90° **XMBHX 90R160**  
 Effective track length: 0,40 m (2-way 0,80 m)

P0  
 X45  
 XS  
 XL  
 XLP  
 X85  
 X85P  
 XH  
 XK  
 XKP  
 XB  
 GR  
 CS  
 XT  
 XC  
 XF  
 XD  
 FST  
 XMY  
 XLX  
**XMJ**  
 GRX  
 CSX  
 ELV  
 CTL  
 TR  
 APX  
 IDX

## Horizontal plain bends XMX

### Horizontal plain bend, 90°

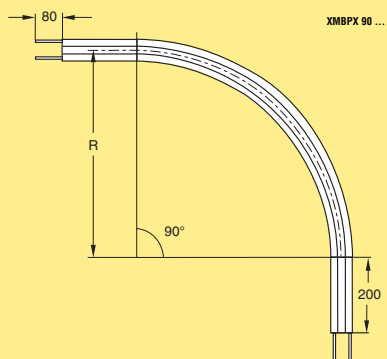

Horizontal plain bend, 90°

R=500

R=1000

**XMBPX 90R500**  
**XMBPX 90R1000**

*Effective track lengths:*

*R500: 1,20 m (2-way: 2,40 m)*

*R1000: 2,00 m (2-way: 3,95 m)*

### Note

Other angles and radii are available on request.

## Vertical bends XMX

### Vertical bend 5°

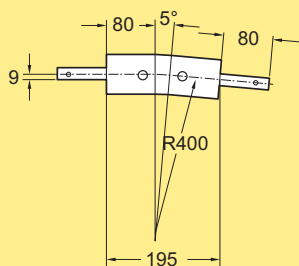

Vertical bend, 5°

**XMBVX 5R400**

*Effective track length: 0,20 m 1-way (0,40 m 2-way)*

### Vertical bend 15°

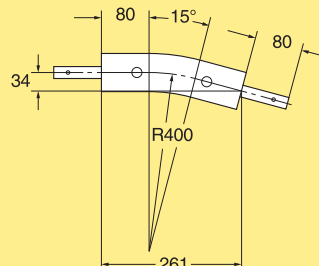

Vertical bend, 15°

**XMBVX 15R400**

*Effective track length: 0,30 m 1-way (0,55 m 2-way)*

### Note

Other angles and radii are available on request.