

Stainless steel conveyor system X85X

Contents

System information	27
Conveyor chain	28
Chain accessories	29
Conveyor beams	30
Slide rails	32
Tools for conveyor beam.....	33
Drive and idler units – introduction	34
Drive units – configuration strings	35

End drive units	36
Idler units	37
Drip catcher.....	38
Bridges, drive unit to idler unit	38
Transfer units	39
Wheel bends X85X	40
Plain bends.....	41
Vertical bends.....	42

P0

XLX

X85X

X180X

X300X

GRX

CSX

FSTX

TR

APX

IDX

System information



Conveyor with focus on robustness and cleanliness

The stainless steel conveyor X85X was designed to suit the requirements of food, personal products, cosmetic, pharmaceutical and dairy applications.

Environment

- Operating temperatures –20 °C to +60 °C
- Operating humidity 10% to 95% RH
- Noise level at 60 m/min is 68 d(BA) or less

Chain width 83 mm

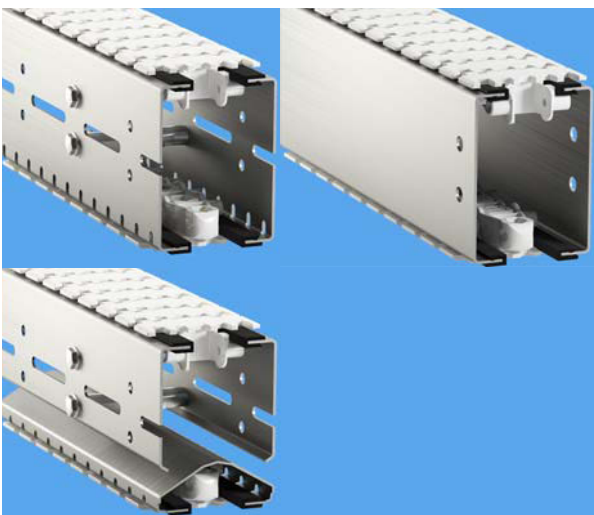

Improved cleanliness conveyor

The X85X conveyor system has been evaluated based on field experience and suggestions from customers. With focus on structure rigidity and robustness, easy design, and easier cleaning, several components have been improved with features like better drainage and smaller contact surfaces.

Compatibility

Note that the new X85X products are possible to use with old XMY systems in certain cases. Please contact your local FlexLink office for more information

Technical characteristics

Drive unit capacity	1250 N
Chain tension limit	1250 N
Beam width	85 mm
Chain width	83 mm
Chain pitch.....	33,5 mm
Item width	70–400 mm
Maximum item weight	15 kg
Maximum weight on conveyor.....	200 kg
Maximum conveyor length	30 m

Conveyor chain

Plain chain

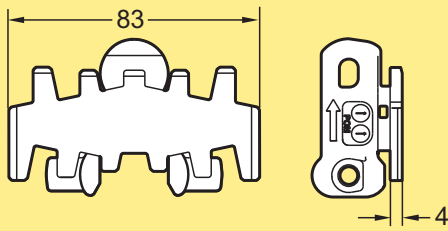

Plain chain
Length 5 m
Standard material
Ultra low wear

XBTP 5A85
XBTP 5A85 C

Plain link kit *
Standard material
Ultra low wear

5110512
5110533

* Link kit contains 10 links, 10 pivots, 10 steel pins
Do not use this chain with pallets type BR or R.

Roller top chain

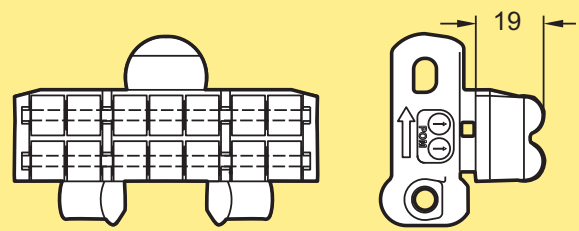

Roller top chain
Length 5 m

XBTR 5A85

Roller top link kit *

5110520

* Link kit contains 10 links, 10 pivots, 10 steel pins

Chain with 23 mm roller cleats

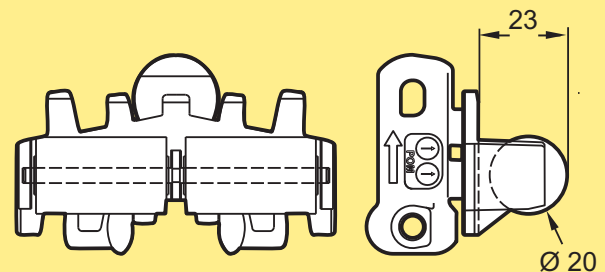

Chain with 23 mm roller cleats *
Length 5 m

XBTF 5A85x23 R

* This product is delivered with plain links between the cleats. Use the online configurator to specify and order.

Roller cleat link kit **

5110521

** Link kit contains 10 links, 10 pivots, 10 steel pins

Friction top chain

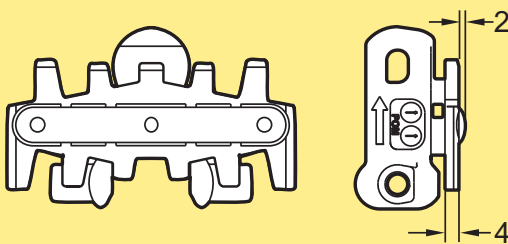

Friction top chain
Length 5 m
All links are friction type
Every 2nd link is friction type

XBTP 5A85 F
XBTP 5A85 F2

Friction top link kit *

5110518

* Link kit contains 10 friction top links, 10 pivots, 10 steel pins

Flexible cleat chain, Type B

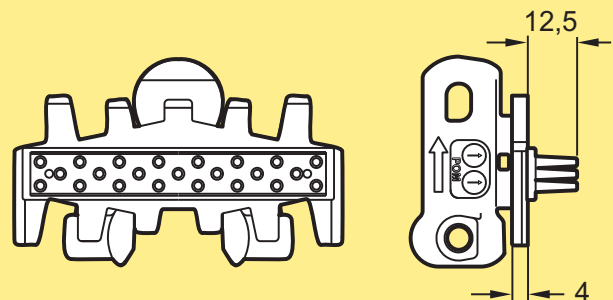

Flexible cleat chain Type B *
Length 5 m

XBTE 5A85 B

* This product is delivered with plain links between the cleats.

Flexible cleat link kit **

5110522

** Link kit contains 10 links, 10 pivots, 10 steel pins

Flat friction top chain

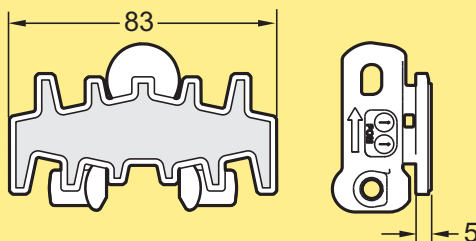

Flat friction top chain
Length 5 m

XBTP 5A85 FA

Friction top link kit *

5110528

* Link kit contains 10 links, 10 pivots, 10 steel pins

Flexible cleat chain, Type C

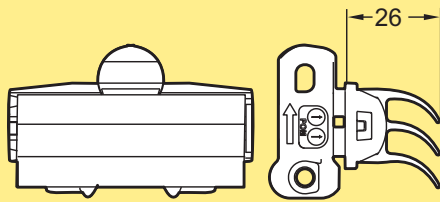

Flexible cleat chain Type C
Length 5 m **XBTE 5A85 C**

Flexible cleat link kit * (link base and flexible cleat top) **5110363**

Flexible cleat top kit (replacement) ** **5110515**

* Link kit contains 10 links, 10 pivots, 10 steel pins
** Cleat kit contains 10 flexible cleat tops

Flexible cleat chain, Type D

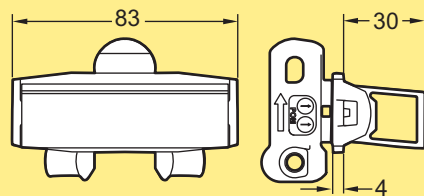

Flexible cleat chain Type D
Length 5 m **XBTE 5A85 D**

Flexible cleat link assembly Type D * (link base and flexible cleat top) **5110582**

Flexible cleat top (replacement) ** **5110524**

* Link kit contains 10 links, 10 pivots, 10 steel pins
** Cleat kit contains 10 flexible cleat tops

Universal chain

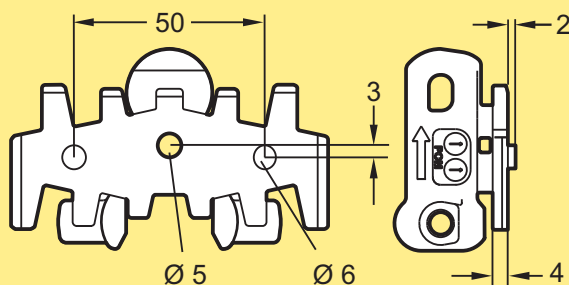

Universal chain*
Length 5 m **XBTF 5A85 U**

* This product is delivered with plain links between the universal links. Use the online configurator to specify and order.

The link has a hole for an M5 screw. An M5 nut will fit inside the link.

Universal link kit ** **5110526**

** Link kit contains 10 links, 10 pivots, 10 steel pins

Other chains

See the Chain guide for selection of other chains.

Note!

Any application incorporating cleated chains requires careful safety consideration. Pinch and shear points are generated throughout the assembly of the incorporated components.

Chain accessories

Pin insertion tool for chain

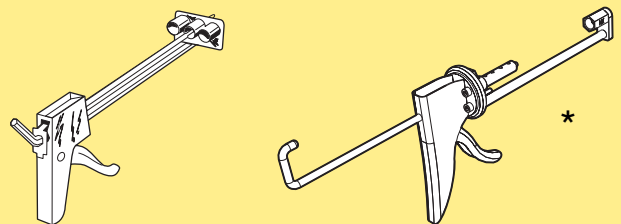

Pin insertion tool
PRO version*

**XMMJ 6
XBMJ 6 P**

*This tool is recommended for frequent users

Stainless steel pin

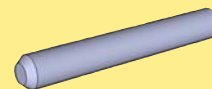

Steel pin
Stainless steel

5111172

Steel pin kit, 25 pc

Plastic pivot for chain



Plastic pivot kit

5111169

Spare parts kit, 25 pcs

Conveyor beams

Conveyor beam, type X, 85 mm

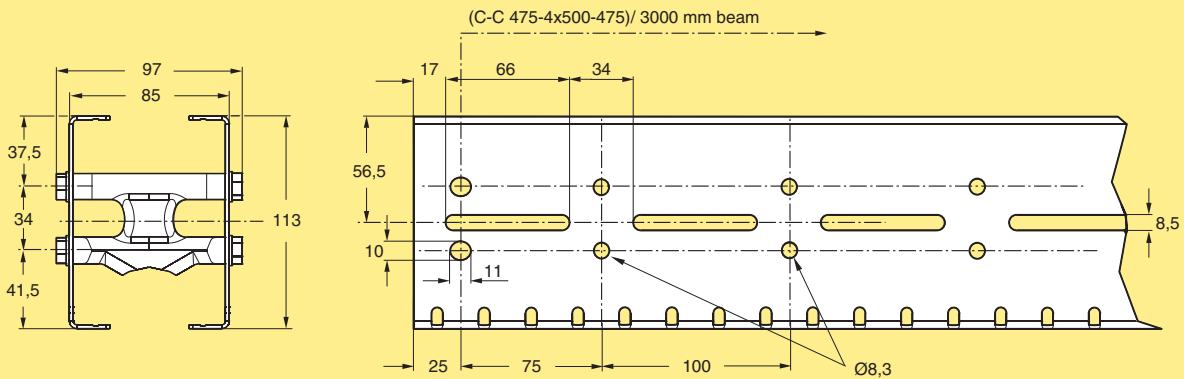

Conveyor Beam

Length 3 m (3000 ±1,5 mm)

Length to order (150- 2999 mm)

XBCBX 3A85

XBCBX LA85

All X85X beams are delivered fully assembled.

Conveyor beam, type Y, 85 mm

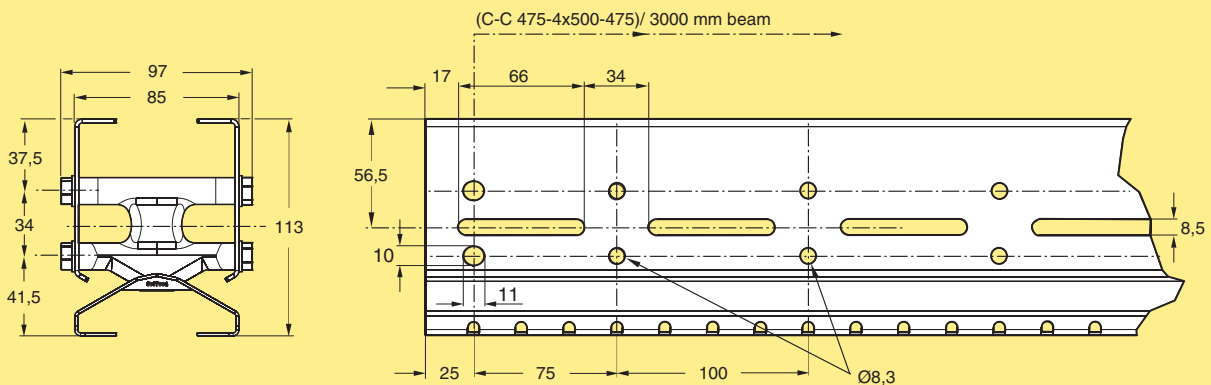

Conveyor Beam

Length 3 m (3000 ±1,5 mm)

Length to order (150- 2999 mm)

XBCBX 3A85Y

XBCBX LA85Y

All X85Y beams are delivered fully assembled, including 2 pcs of Screw kit 5114562.

Conveyor beam, type C, 85 mm

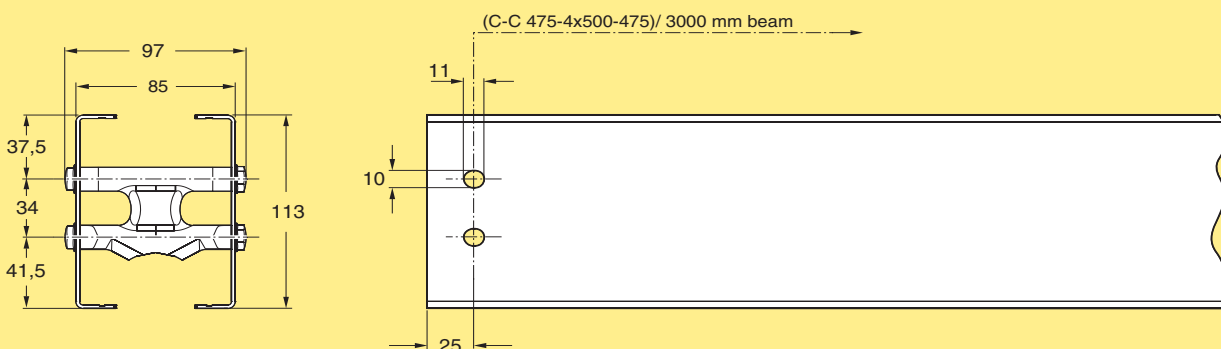

Conveyor Beam

Length 3 m (3000 ±1,5 mm)

Length to order (150- 2999 mm)

XBCBX 3A85C

XBCBX LA85C

All X85X beams are delivered fully assembled.

Beam spacer kit

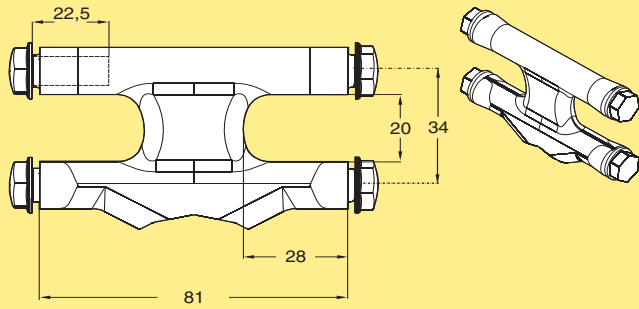

Beam spacer kit for X85X **XBCEX A85**
Stainless steel

Including screws.
The beams have predrilled 8,3 mm holes at 100 mm intervals that need to be increased to 10 mm see figure.

Connecting bracket kit

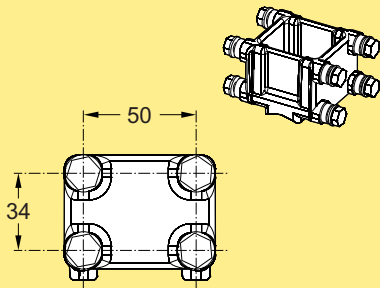

Connecting bracket kit for X85X and X85Y, used to joint two beams see figure.
XBCJX A85
Stainless steel

Including screws.
The beams have predrilled 10 mm holes, see XBCBX 3A85.

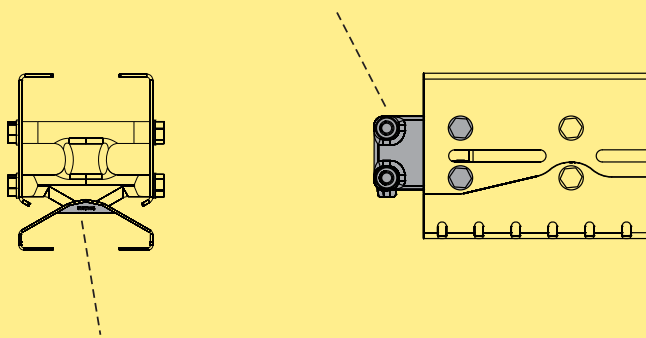

Screw kit



Screw kit **5114562**
For return beam, type Y, 85 mm, or Drip catcher kit.

Beam section for chain installation

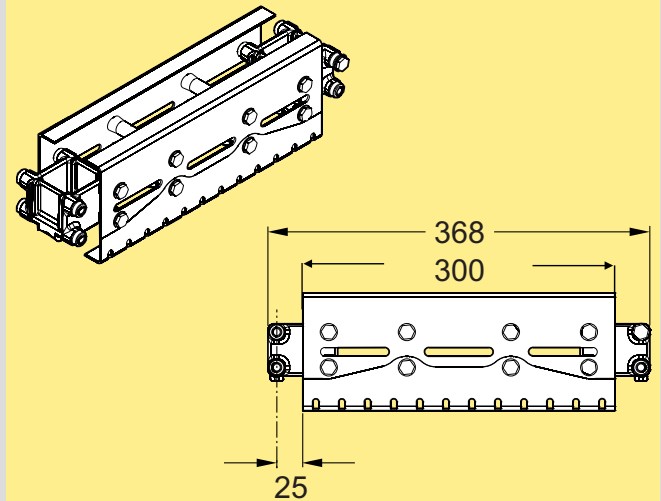

Beam section for chain installation **XBCCX 300A85**
Including 2 Connecting brackets
XBCJX A85

Nut, stainless steel

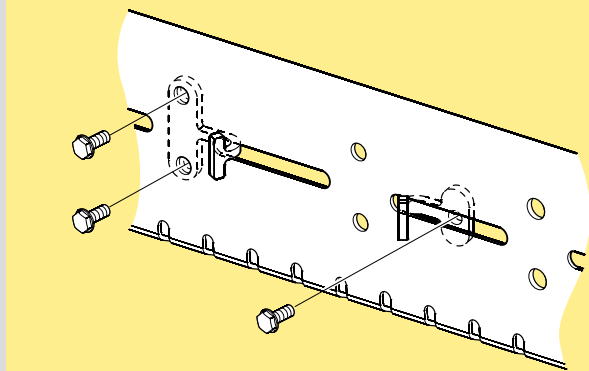
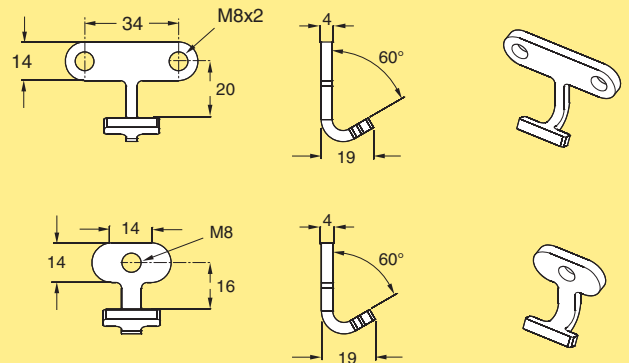

Nut 2xM8 **5113998**
Nut 1xM8 **5114181**

Nut with threaded hole (M8) for connection of sensors and other accessories when the conveyor chain is in place. By placing nuts inside the beam at the holes, accessories can be attached using M8 A4 screws.
NOTE! Be careful when installing so no nut is dropped inside the beam, this can lead to a large additional work or operational damage.

Slide rails

Plastic slide rails, narrow

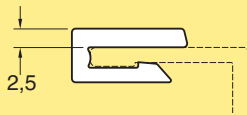

Slide rail

Length 25 m

HDPE (Black)

PE-UHMV (White)

PVDF (Transparent white)

PA-PE (Grey) (Should not be used in wet applications)

XBCR 25

XBCR 25 U

XBCR 25 P

XBCR 25 H

Plastic slide rails, wide

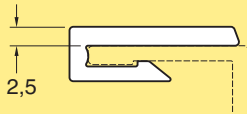

Slide rail

Length 25 m

HDPE (Black)

PE-UHMV (White)

PVDF (Transparent white)

PA-PE (Grey) (Should not be used in wet applications)

XBCR 25 B

XBCR 25 UB

XBCR 25 PB

XBCR 25 HB

Note. The wide slide rails are not suitable for use in bends.

Mounting tool for slide rail

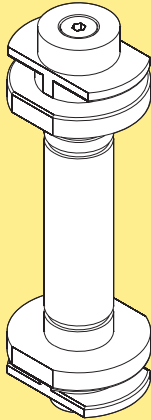

Mounting tool for slide rail

XBMR 170

Stainless steel rivet

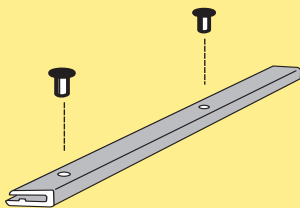

Stainless steel rivet, 4 mm

XLAHX 4x7

Note. Must be ordered in multiples of 25

Drill fixture for slide rail

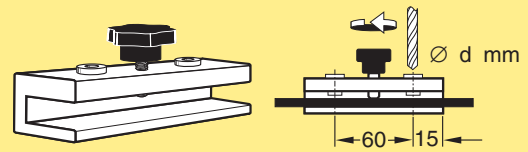

Drill fixture for slide rail

d=4,2 mm

3920500

Rivet crimping pliers



Rivet crimping pliers

For 4 mm rivets

5051395

Rivet crimping clamp

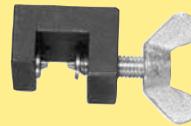

Rivet crimping clamp

For 4 mm rivets

3923005

Drill fixture

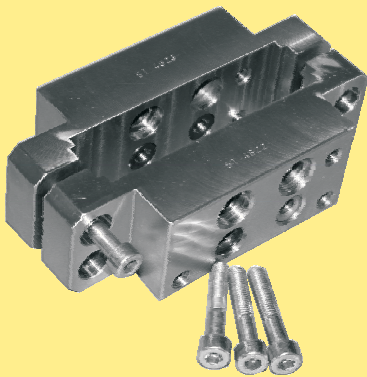

Drill fixture

5114621

For use when additional holes are needed on the beam sides.

Including:

Drill 4,5 mm

Drill 8,3 mm

Drill 11,0 mm

and instructions for use.

Drill



Twist Drills DIN 338 HSS-E (Co 8)

Type N-HD Cobalt Alloyed, Split Point

Drill 11,0 mm

5115050

Drill 10,2 mm

5115056

Drill 8,3 mm

5115051

Drill 4,5 mm

5115052

Drill 4,2 mm (for 3920500)

5115053

For high strength alloys on CrNi base such as Hastelloy, Inconel, Monel, Nimonic, stainless steels, heat and acid-proof steels (up to 1400 N/mm² tensile strength).

Drive and idler units – introduction

Drive unit types

The X85X system drive units capacities is maximum 1250 N. The actual capacity depends on the speed.

Available motors include variable speed types (**V**) as well as fixed speed motors (**F**).

End drive units

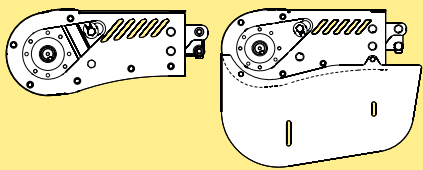
Size	Direct drive, no slip clutch
	
Drive unit	F, V
Drive unit, guided	F, V

Motor specifications

Motors are available for 230/400 V, 50 Hz and 230/460 V or 330/575 V, 60 Hz. Variable speed motors are SEW Movimot, 380–500 V. Note that variable speed motors include a control box that adds 93 mm to the width of the motor.

IP class 65 and available with standard oil and food grade oil

Idler unit types

Idler units are available in two versions, Compact and Standard

Ordering information

Drive units with motors must be specified using the web-based configurator. The configurator provides detailed information and step-by-step guidance in the specification process. A product code string is generated, containing the specification details. See next page for examples of code strings.

Drive units *without* motors can be ordered using the designations in the catalogue.

Dimension drawings in catalogue

Note that dimensions relating to drive unit motors depend on the motor specified during the configuration. In most cases, the motors shown in the catalogue drawings represent the largest size. If variable speed motors are used, some dimensions may increase, indicated by dimension values xxx (V: yyy). V represents the max dimension using variable speed motor.

Drive units – configuration strings

Below, two examples of text strings obtained from the configurator with explanations are presented.

Drive unit with fixed speed motor

Item no	A	B	C	D	E	G	H	I
XBEBX A85	HNP	- L	- G	- V4	- SA37	- 50/230	- 0,18kW	- TF

Drive unit with variable speed motor

Item no	A	B	D	E	F	G	J	K
XBEBX A85	HNPV	- L	- V6-15	- SA37	- MM03	- 50/380-500	- C	- P

Item no - Drive type

XBEBX: End drive

H – Motor power

... kW: Motor power, kW
(position is omitted for variable speed motors
see position F)

A – 0-Unit

HNP: Direct drive, no slip clutch
....V: Variable speed

I – Thermal protection

No: No thermal protection
TF: Thermal protection type TF
TH: Thermal protection type TH
(position is omitted for variable speed motors)

B – Motor position

L: Left
R: Right

J – Hybrid cable

No: No hybrid cable
C: Hybrid cable included in SEW Movimot
(position is omitted for fixed speed motors)

C – End drive with guided chain

G: Guided (position is omitted for non-guided)

D – Speed

V...: Fixed speed... m/min
V... -...: Variable speed range...-... m/min

K – Fieldbus

No: No fieldbus
P: Profibus fieldbus, maintenance switch
D: DeviceNet fieldbus, maintenance switch
(position is omitted for fixed speed motors)

E – Gearbox

SA37: SEW motor type SA37

F – Movimot size

MM03: SEW Movimot type, 0,33 kW
MM05: SEW Movimot type, 0,55 kW
MM07: SEW Movimot type, 0,75 kW
MM11: SEW Movimot type, 1,1 kW
(position is omitted for fixed speed motors)

G – Electrical environment

50/230: 50 Hz, 230 V
50/400: 50 Hz, 400 V
60/230: 60 Hz, 230 V
60/460: 60 Hz, 460 V
60/575: 60 Hz, 575 V
50/380-500: SEW Movimot variable speed motor
60/380-500: SEW Movimot variable speed motor

End drive units

End drive unit, direct drive, no slip clutch

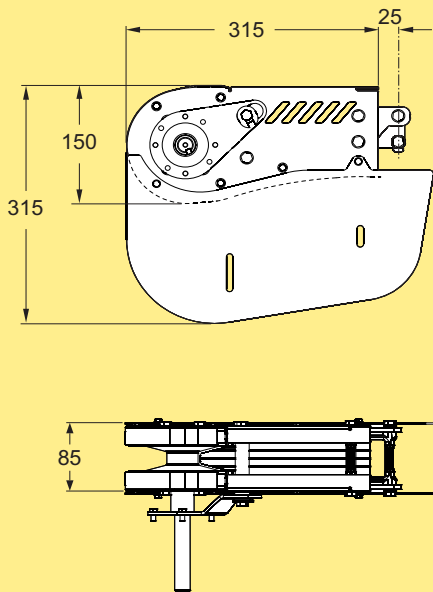

End drive unit

Direct drive. No slip clutch.
Maximum traction force: up to 1250 N.
Maximum speed 120 m/min for X85X.

Motor on left side:

Fixed/variable speed * **XBEBX A85**
Without motor **XBEBX 0A85HNLP**

Motor on right side (not shown):

Fixed/variable speed * **XBEBX A85**
Without motor **XBEBX 0A85HNRP**

* Use online configurator when ordering.

Effective track length: 0,70 m

End drive unit, guided chain, no slip clutch

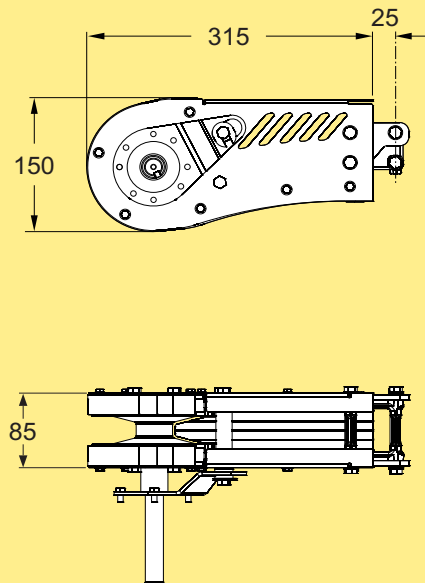

End drive unit

Direct drive with guided chain. No slip clutch.
Maximum traction force: up to 1250 N.
Maximum speed 120 m/min for X85X.

Motor on left side:

Fixed/variable speed * **XBEBX A85**
Without motor **XBEBX 0A85HNLGP**

Motor on right side (not shown):

Fixed/variable speed * **XBEBX A85**
Without motor **XBEBX 0A85HNRGP**

* Use online configurator when ordering.

Effective track length: 0,70 m

Guide wheel kit



Guide wheel for drive units **5055635**

Including wheel, shaft and mounting hardware.
Note. Can only be used with plain chain. For use in high speed operation (60 m/min and above).

Idler end unit

Idler end unit X85X **XBEJX A85**
 Effective track length: 0,70 m.

Idler end unit, Compact

Idler end unit X85X **XBEJX A85 S**
 Effective track length: 0,35 m.

Protective cover for Idler end unit

Protective cover for Idler end unit XBEJX A85 **XBSJX A85**

Protective cover for Idler end unit, Compact

Protective cover for Idler end unit XBEJX A85 S **XBSJX A85 S**

Note!

Always consider protective cover for idler ends when closed top chain XBTP 5A85 V is used.

Drip catcher

Drip catcher kit

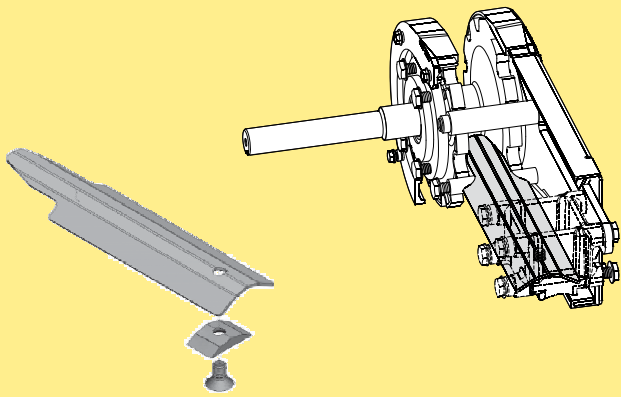

Drip catcher kit

5114763

For drive units and idler ends, to be used together with conveyor beams type Y with protected return beams including 5114562 Screw kit.

Screw kit

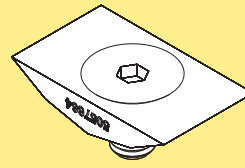

Screw kit

5114562

For return beam, type Y, 85 mm, or Drip catcher kit.

Bridges, drive unit to idler unit

Bridge, idler compact to drive unit

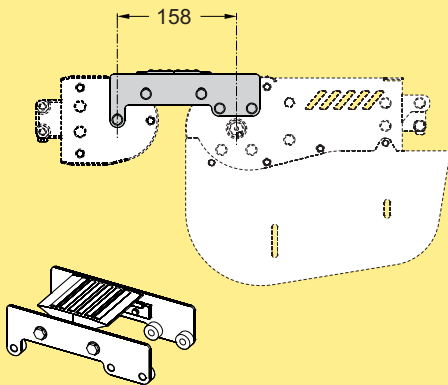

Bridge (see Note)

5115194

Including roller bridge and mounting hardware. Suitable for connecting idler compact to drive unit.

Bridge, idler to drive unit

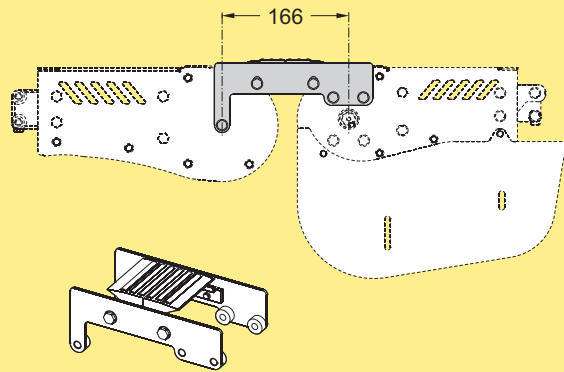

Bridge (see Note)

5115195

Including roller bridge and mounting hardware. Suitable for connecting idler to drive unit.

X-bend, left

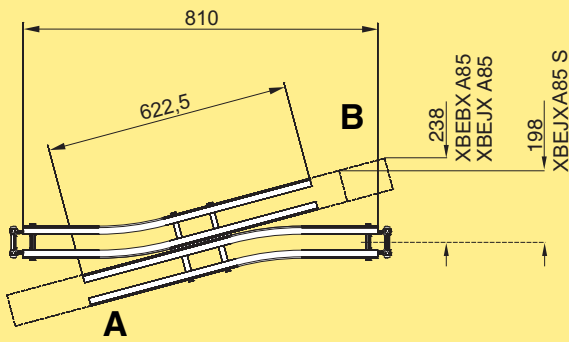

X-bend for return chain

For optional mounting of Idler end unit or Drive unit at the end (A) or (B) **XBCXX 85 DL**

Effective track length: 2,84 m

Side transfer, right

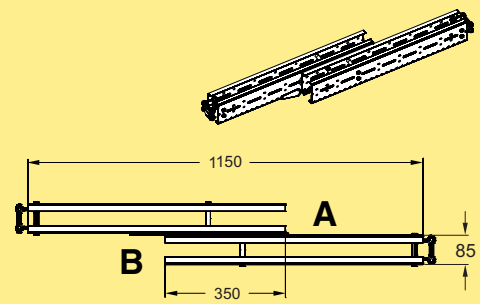

Side transfer

For optional mounting of Idler end unit or Drive unit at the end (A) or (B) **XBCPX 85 R**

Effective track length: 3 m

X-bend, right

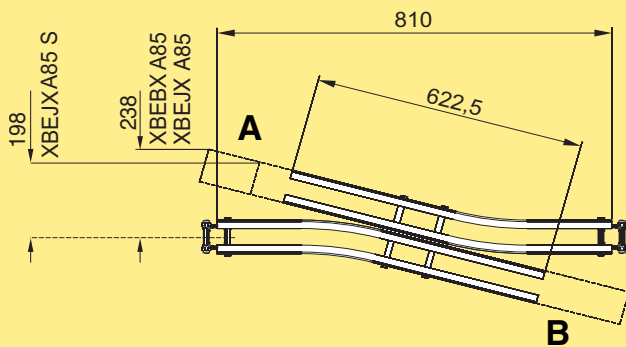

X-bend for return chain

For optional mounting of Idler end unit or Drive unit at the end (A) or (B) **XBCXX 85 DR**

Effective track length: 2,84 m

Slack protection kit

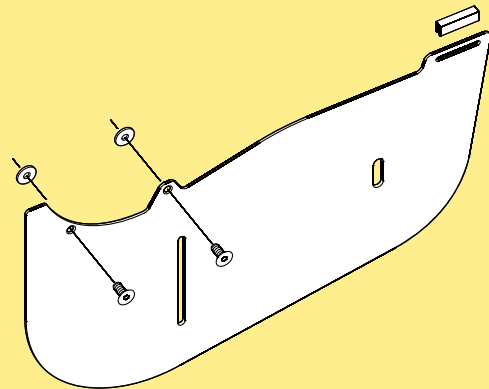

Slack protection kit

5115027

Recommended use when Side transfer is installed with End drive unit, direct drive, no slip clutch.

Side transfer, left

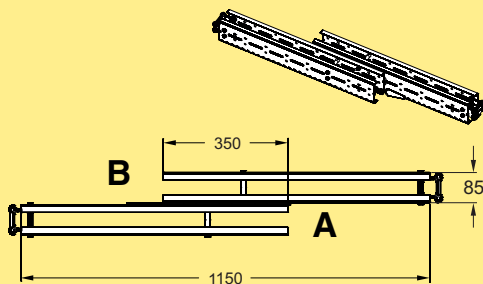

Side transfer

For optional mounting of Idler end unit or Drive unit at the end (A) or (B) **XBCPX 85 L**

Effective track length: 2,84 m

Wheel bends X85X

Wheel bend, 30°

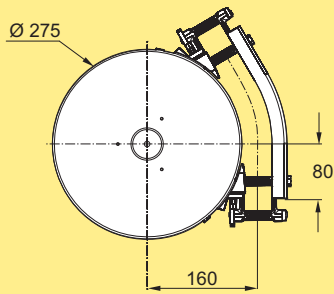

Wheel bend, 30°
Wheel bend, 30° type C

XBBHX 30A85R160
XBBHX 30A85R16C

Effective track length (top + bottom): 0,50 m

Wheel bend, 90°

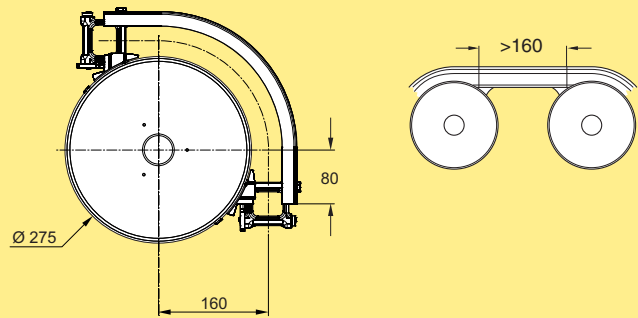

Wheel bend, 90°
Wheel bend, 90° type C

XBBHX 90A85R160
XBBHX 90A85R16C

Effective track length (top + bottom): 0,85 m

Wheel bend, 45°

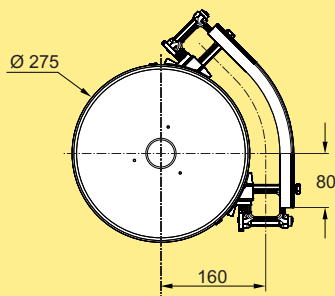

Wheel bend, 45°
Wheel bend, 45° type C

XBBHX 45A85R160
XBBHX 45A85R16C

Effective track length (top + bottom): 0,60 m

Wheel bend, 180°

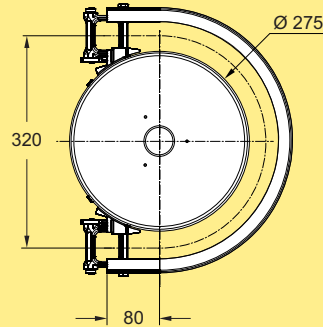

Wheel bend, 180°
Wheel bend, 180° type C

XBBHX180A85R160
XBBHX180A85R16C

Effective track length (top + bottom): 1,35 m

Plain bends

P0

Item no	Angle (a)	Radius (R)	Effective track length	Slide rails (m)
XBBPX 30A85R5	30°	500 mm	0,70 m (1,40 m 2-way)	2,70 m
XBBPX 30A85R7	30°	700 mm	0,80 m (1,60 m 2-way)	3,10 m
XBBPX 30A85R10	30°	1000 mm	0,92 m (1,85 m 2-way)	3,70 m
XBBPX 45A85R5	45°	500 mm	0,80 m (1,60 m 2-way)	3,20 m
XBBPX 45A85R7	45°	700 mm	0,95 m (1,90 m 2-way)	3,80 m
XBBPX 45A85R10	45°	1000 mm	1,12 m (2,40 m 2-way)	4,70 m
XBBPX 90A85R5	90°	500 mm	1,20 m (2,40 m 2-way)	4,50 m
XBBPX 90A85R7	90°	700 mm	1,50 m (3,0 m 2-way)	5,60 m
XBBPX 90A85R10	90°	1000 mm	2,00 m (4,0 m 2-way)	7,80 m

XLX

X85X

X180X

X300X

GRX

CSX

FSTX

TR

APX

IDX

Plain bend, 30°

Support rail on inner beam included

Plain bend, 30° X85X
R=500 mm
R=700 mm
R=1000 mm

**XBBPX 30A85R5
XBBPX 30A85R7
XBBPX 30A85R10**

Plain bend, 90°

Support rail on inner beam included

Plain bend, 90° X85X
R=500 mm
R=700 mm
R=1000 mm

**XBBPX 90A85R5
XBBPX 90A85R7
XBBPX 90A85R10**

Plain bends, 45°

Support rail on inner beam included

Plain bend, 45° X85X
R=500 mm
R=700 mm
R=1000 mm

**XBBPX 45A85R5
XBBPX 45A85R7
XBBPX 45A85R10**

Support rail for plain bends

Support rail for plain bends,
Length 2,4 m
Polyamide

5048598

Fix with sheet metal screw ISO 7049 4,2x9,5 or similar.

Vertical bends

Vertical bend, positive angle

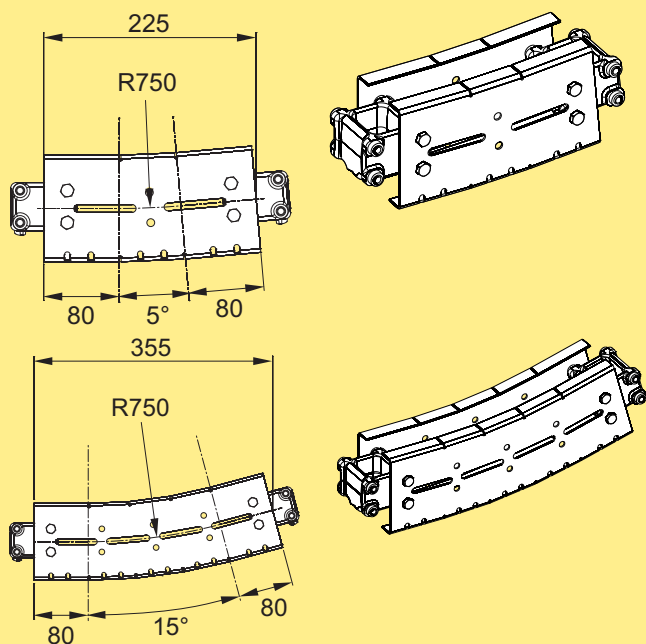

Vertical bend, pos., 5° **XBBVX 5A85R7P**
 Vertical bend, pos., 15° **XBBVX 15A85R7P**

Effective track length (top + bottom): 5°: 0,50 m, 15°: 0,75 m

Vertical bend, negative angle

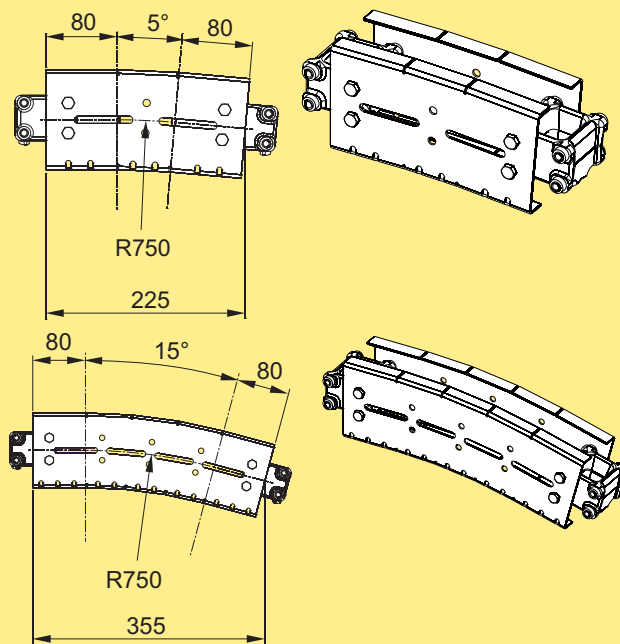

Vertical bend, neg., 5° **XBBVX 5A85R7N**
 Vertical bend, neg., 15° **XBBVX 15A85R7N**

Effective track length (top + bottom): 5°: 0,50 m, 15°: 0,75 m