

LB-03/06

Live Bottom Prefeeder



Product Overview:

Shibuya Hoppmann's standard LB-03 and LB-06 overhead prefeeders are designed to handle small to medium sized parts and are engineered to interface directly with smaller style parts feeders. A variable speed motor drives the belt at a speed of 23.00 inches per minute. **Note: Controllers and mechanical level sensors are not supplied with this unit.**

Part Number	LB03XXXDSA	LB03XXXASA
Motor Style	DC	AC
Motor Voltage	90V	208-230/460V
Horsepower	1/30hp	1/8hp
Total Equipment Weight	110 lbs.	50 kg
Hopper Capacity (LB-3)	3 ft ³	85 liters
Hopper Capacity (LB-6)	6 ft ³	170 liters

Standard Features:

- ✓ Stainless steel construction
- ✓ Durable reinforced black neoprene belt with fiberglass cord
- ✓ Feeder mounting brackets

Available Options:

- ✓ Continuous welded seams
- ✓ Hopper covers
- ✓ Tan neoprene USDA/FDA dry contact food belt with fiberglass cord (Food Grade Unit: LB03XXXDFA and LB03XXXAFA)
- ✓ NEMA 1 encased controller

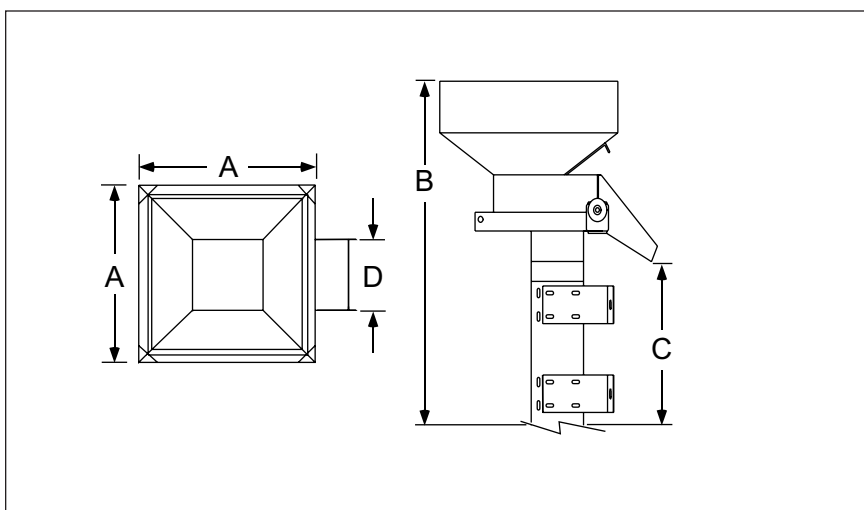

Product Specifications	ANSI	Metric
A Hopper Width and Length	24" x 24"	610 x 610mm
B Overall Height – LB-03	37"	940mm
B Overall Height – LB-06	47.5"	1207mm
C Discharge Height	17.5"	445mm
D Belt Width	9.9"	252mm

Shibuya Hoppmann Corporation strives to improve its products and reserves the right to change or discontinue specifications & designs shown in this brochure without notice and without incurring obligation. Revised: 05/10.

**automatic
feeder
company** inc.

Your Local Representative:

Automatic Feeder Company Inc.

921 Albion Avenue Schaumburg, IL 60193-4550

Phone: (847) 534-2300 Toll-Free: (888) 534-2340 Fax: (847) 534-2354

www.automaticfeeder.com Email: sales@automaticfeeder.com



Shibuya Hoppmann

INTEGRATION THROUGH INNOVATION