

WEP-80 Wide Belt Elevating Prefeeder



Product Overview:

The WEP-80 wide belt elevating prefeeder is specially designed to handle large parts. Two independently controlled variable speed drives ensure gentle product metering. Designed for floor level parts loading, the 80 ft³ capacity hopper delivers product at an average belt speed of 23 feet per minute. The cleated elevator belt has a nominal cleat height of 4" and a cleat pitch of 12", allowing for maximum product loading. **Note: Controllers and mechanical level sensors are not supplied with this unit.**

Part Number	WEP80XXDSA	WEP80XXASA
Motor Style	DC	AC
Motor Voltage	90V	230/460V
Horsepower (Horizontal)	1/2hp	1/2hp
Horsepower (Elevator)	1/2hp	1/2hp
Total Equipment Weight	2462 lbs.	1117 kg
Hopper Capacity	80 ft ³	2266 liters

Standard Features:

- ✓ Stainless steel construction
- ✓ Sensor controlled dual belt metering system
- ✓ Horizontal belt is FDA/USDA approved white buna-n/polyester polyflake endless belting
- ✓ Elevator Belt is FDA/USDA approved white 1-ply solid woven polyester fabric with .156" thick white PVC coating and PVC cleats

Available Options:

- ✓ Elevator extensions *
- ✓ Continuous welded hopper seams
- ✓ Elevator/hopper covers
- ✓ Washdown motor
- ✓ NEMA 1 encased controller
- ✓ Clean out doors
- ✓ Casters

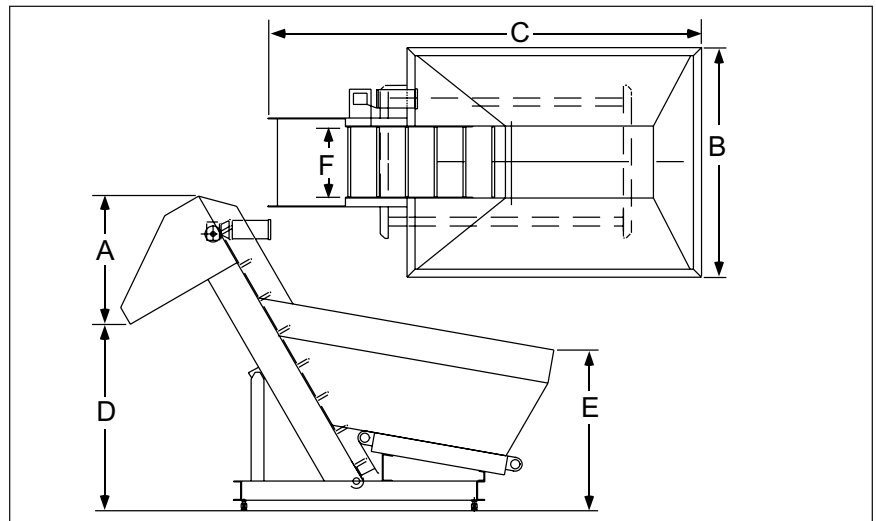

Product Specifications	ANSI	Metric
A Discharge Chute Height	40"	1016mm
B Overall Width	72"	1829mm
C Overall Length	136"	3454mm
D Dump Height (Adjustable)	58"	1473mm
E Hopper Load Height	50"	1270mm
F Belt Width (Elevator)	22"	559mm

Shibuya Hoppmann Corporation strives to improve its products and reserves the right to change or discontinue specifications & designs shown in this brochure without notice and without incurring obligation. Revised: 05/10.

**automatic
feeder
company** inc

Your Local Representative:

Automatic Feeder Company Inc.

921 Albion Avenue Schaumburg, IL 60193-4550

Phone: (847) 534-2300 Toll-Free: (888) 534-2340 Fax: (847) 534-2354

www.automaticfeeder.com Email: sales@automaticfeeder.com



Shibuya Hoppmann

INTEGRATION THROUGH INNOVATION